



NKE-SS Loadcell

NKE-SS



NKE-SS

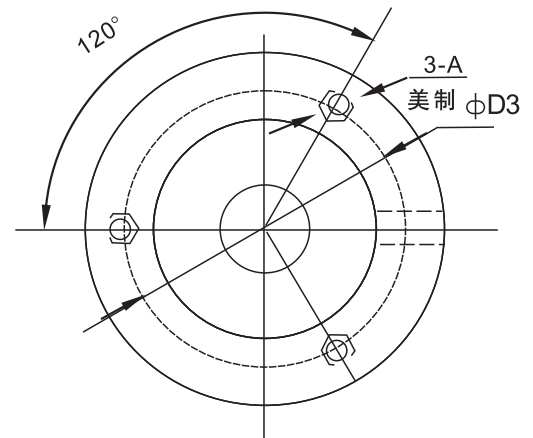
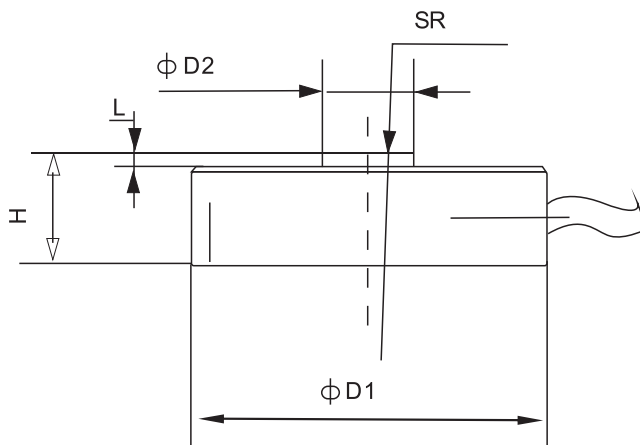

Rated Load(lb)	D1	D2	D3	H	L	A	SR
200~2000	32	8.1	25.4	10	1.8	#6-32UNC	35
3000~5000	38	11	31.4	16	2.0	#6-32UNC	35

Pressure testing for small space

TECHNICAL PARAMETER | OAP version 4Wires:Exc+(Blue);Exc-(Black);Sig+(White);Sig-(Red)

Rated capacities(Emax)	200,500lb;1,2,3,5klb	Temperature range, compensated	-10°C~+40°C
Sensitivity	1.0~0.5mV/V	Temperature range, operating	-30~+70°C
Total error	±0.5%F.S; ±1%F.S(3~5klb)	Maximum safe overload	100%F.S
Creep error (30min)	±0.3%F.S	Ultimate overload	120%F.S
Zero balance	±1%F.S	Excitation, recommended	10V DC
TC ZERO	±0.05%F.S/10°C	Excitation, maximum	10V DC
TC SPAN	±0.05%F.S/10°C	Protection class	IP67
Input resistance	380 ± 30 Ω	Construction	Stainless Steel
Output resistance	350 ± 5 Ω (2~10klb); 352 ± 3 Ω (50lb~1klb);	Cable	Length: 1.5m
Insulation resistance	≥5000MΩ		Diameter: φ 3mm